

# Quantum®

32 Wedgwood Road, Bicester,  
 Oxon, OX26 4UL  
 Phone: 01869 324600  
 Fax: 01869 323070  
 Email: sales@quantumrehab.co.uk  
 Web: www.quantumrehab.co.uk



## Dealer April 2021



### Q610 with Synergy® Seating & VR2 Controls

Dealer Name: \_\_\_\_\_ Order Date: \_\_\_\_\_

Address: \_\_\_\_\_

\_\_\_\_\_

\_\_\_\_\_ Post Code: \_\_\_\_\_

Phone \_\_\_\_\_ Email: \_\_\_\_\_

PO No: \_\_\_\_\_ Order Ref: \_\_\_\_\_

Delivery Address: \_\_\_\_\_

\_\_\_\_\_

\_\_\_\_\_ Post Code: \_\_\_\_\_

Quantum Specialist: \_\_\_\_\_

### Standard Features

- Synergy Seating System
- 4" of Seat Width Adjustment
- 4" of Seat Depth Adjustment
- 2 x 30ah batteries
- VR2 Joystick
- Omni Front & Rear Castors, Flat Free
- 3" x 10" Pneumatic Drive Tyres
- 5 Colour Options
- 4 Mph (6 Km/h) Motors
- ATX Suspension System
- Single Post Height Adj. Removable Armrests
- Flip-up footboard
- Maximum User Weight 21 Stone 6lbs
- Synergy Simplicity Seat Cushion
- Tie-Down System for Transport

Standard = Standard Factory Feature | FOC = Select instead of Standard Factory Feature

### Base Model

**Q610 with Synergy® Seating and VR2 Controls - £3,750.00**

### Drive Wheels

- 3" x 10" Pneumatic, Black Tyres Standard
- 3" x 10" Flat Free, Black Tyres £125.00

### Castor Wheels

- 2" x 6" Flat Free, Rear Black Tyres, Standard
- 2" x 5" Flat Free, Front Tyres Standard

### Colours



### Seat Dimensions

Select width and depth package and enter desired seat width and depth in that package range, available in 1" increments. Maximum seat size is 20"W x 20"D.

#### Seat Width Packages

- 14"W-18"W       16"W-20"W
- Set Width at: \_\_\_\_\_ (Max seat width 20")

#### Seat Depth Packages

- 14"D-18"D       16"D-20"D
- Set Depth at: \_\_\_\_\_ (Max seat depth 20")

## Seat Cushions

- |   |          |
|---|----------|
| <input type="checkbox"/> No Seat Cushion Required   | FOC      |
| <input type="checkbox"/> Simplicity Cushion: <i>General Use</i>                           | Standard |
| <input type="checkbox"/> TRU-Comfort™2 4-Way Stretch: <i>Skin Protection</i>              | £45.00   |
| <input type="checkbox"/> Solution® Cushion: <i>Skin Protection &amp; Positioning</i>      | £100.00  |
| <input type="checkbox"/> Solution® 1 Cushion: <i>Skin Protection</i>                      | £100.00  |
| <input type="checkbox"/> Spectrum® Gel Cushion: <i>Positioning</i>                        | £160.00  |
| <input type="checkbox"/> Spectrum® Foam Cushion: <i>Skin Protection &amp; Positioning</i> | £160.00  |

Refer to cushion matrix for size availability and enter your selection here:    W..... X D.....

## Synergy® Backrest Specifications

- |   |          |
|---|----------|
| <input type="checkbox"/> Synergy® Backrest Assembly <i>Including Visco padded backrest</i>                          | Standard |
| <input type="checkbox"/> Tension Adjustable Backrest Upholstery <i>This option may increase the delivery time</i>   | £120.00  |
| <input type="checkbox"/> Back Canes Only <i>Suitable for third party backrests. A backrest will not be supplied</i> | FOC      |

### Backrest/Back Cane Height:

Set Backrest/Back Cane Height at: \_\_\_\_\_ (Available in 1" increments. Min 13", Max 25") *Please refer to Synergy Backrest Matrix on page \* for seat width and backrest height compatibility*

Back Height = Seat Pan to Top of Back | Odd heights = 4" gap at bottom, Even heights = 3" gap at bottom.

## TRU-Comfort Plus® Backrest Specifications

- |  |          |
|--|----------|
| <input type="checkbox"/> TRU-Comfort Plus® Backrest Assembly <i>4-way stretch fabric (Positioning). Only available with seat widths 16", 18" and 20"</i> | £220.00  |
| <b>Backrest Height:</b>  |          |
| <input type="checkbox"/> 27" Tall  | Standard |
| <input type="checkbox"/> 24" Tall  | FOC      |

Back Height = Seat Pan to Top of Back | 3" gap at bottom.

## Seat Positioning Adjustments

- |  |          |
|--|----------|
| <input type="checkbox"/> Static Seat   | Standard |
| <input type="checkbox"/> TRU-Balance®2 Power Tilt <i>0-55 degree centre of gravity (CG) power tilt seating system. Uses 1 power option</i> | £990.00  |
| <b>Seat to Floor Height</b>  |          |
| Static Seat <input type="checkbox"/> 15.75" Seat to Floor <input type="checkbox"/> 16.75" Seat to Floor                                    | Standard |
| Static Seat extended height <input type="checkbox"/> 17.75" Seat to Floor <input type="checkbox"/> 18.75" Seat to Floor                    | £152.00  |
| TB2 Power Tilt <input type="checkbox"/> 17.5" Seat to Floor  | FOC      |

## Backrest Positioning Adjustments

- |  |          |
|--|----------|
| <input type="checkbox"/> Static Backrest <i>Tool angle adjustable from 85° to 120° in 5° increments</i>  | Standard |
| <b>Additional Static Back Options:</b>   |          |
| <input type="checkbox"/> Flip Forward Backrest <i>Not suitable for occupied transportation</i>   | £200.00  |
| <input type="checkbox"/> 1" Endo Brackets <i>Reduces backrest width by 2". Not available with TRU-Comfort Plus backrest on seat widths 14"-17"</i> | £40.00   |
| <input type="checkbox"/> 2" Endo Brackets <i>Reduces backrest width by 4". Not available with TRU-Comfort Plus backrest on seat widths 14"-19"</i> | £40.00   |

## Armrests

- |   |          |
|---|----------|
| <input type="checkbox"/> Single Post, Quick Height Adjustable Removable Armrests, Pair <i>Height adjustment from 11" - 17" in 1/2" increments</i>   | Standard |
| <input type="checkbox"/> Single Post, Tool Height Adjustable Armrests, Heavy Duty, Removable, Pair  | £220.00  |
| <input type="checkbox"/> 8"-12" Height Range <input type="checkbox"/> 10"-14" Height Range  |          |
| <input type="checkbox"/> Paediatric, Removable, Height Adjustable <i>Height adjustment from 7.75" to 9.75" in 1/2" increments. Not available with full length arm pads</i>  | FOC      |
| <input type="checkbox"/> Cantilever Flip-Up Armrests, Pair <i>Not available with a tension adjustable backrest. Increases overall width by 7". Height adj. 11"-17" depending on backrest height. Not available with Flip Forward Backrest. Not available with TB2 Power Recline</i> | £280.00  |
| <input type="checkbox"/> 2-Post, Flip Back, Height Adjustable, Removable <i>Height range 9"-13". Not available with a seat depth less than 16"</i>  | £145.00  |

## Armrests Pad Options

- |   |          |
|---|----------|
| <input type="checkbox"/> 14"L x 2"W Straight, Pair <input type="checkbox"/> 10"L x 2"W Straight, Pair   | Standard |
| <input type="checkbox"/> 14"L x 3"W Waterfall, Pair <input type="checkbox"/> 10"L x 3"W Waterfall, Pair | FOC      |
| <input type="checkbox"/> 14"L x 3.5"W Gel Armpad, Pair  | £160.00  |

## Armrests Pad Options (continued)

10"L x 3.5"W Gel Armpad, Pair £130.00

### Ottobock Arm Channel (Each)

Medium (4.75" x 11.5") *Desk length armrest required* £140.00

Large (4.75" x 14") *Full length armrest required* £140.00

One Piece (4.75" x 18") *Full length armrest required. Not compatible with Hand Pad.* £140.00

Ottobock Hand Pad *Not available on same side as controller* £50.00

Medium       Large

### Ottobock Arm Channel Mounting Position

Left       Right       Both *Please amend price for pair*

## Headrests

Quantum 10" W Headrest £120.00

Stealth Small Contoured 9.75"W x 3"H £150.00

Stealth Large Contoured 11"W x 6"H £150.00

Stealth 10" Comfort Plus £180.00

Stealth 14" Comfort Plus £180.00

*Please visit [www.stealthproducts.com](http://www.stealthproducts.com) for more headrest options*

## Centre Mount Foot Platforms

Base Mounted Foot Platform *Mounted to chassis, will not move with Power Tilt or Seat Lift* Standard

Adjustable Centre Mount Foot Platform *Mounted to Seat* £326.00

Centre Mount Power Articulating Foot Platform *Mounted to Seat* £1,320.00

### Footplates

10"W x 11"D Split Footplates:      or       10"W x 8"D Split Footplates Standard

### Lower Extensions *Seat pan to Heel*

10-16"L *Seat pan to heel*      or       13-19"L *Seat pan to heel* Standard

### Calf Pads, Pair

Small 6"H x 6"W      or       Large 8"H x 8"W, tapered to 6"W £40.00

### Calf Panel

Small 8"H x 18"W      or       Large 8"H x 24"W *Only available on 20" seat width or greater.* £84.00

Calf Panel Extension (each) £30.00

### Footplate Extension Kits

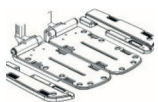

4" Width Extension Kit £16.00

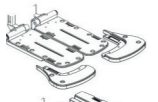

2" Bell Shaped, Length Extension Kit £16.00



4" Width Extension with 2" Bell Shaped, Length Extension Kit £28.00

### Additional Optional Accessories:

Wheel Bumpers, Pair £5.00

Footplate Connector £10.00

## Individual Legrests

*Choose instead of centre mount foot platform options*

- 60-90° Swing-Away Legrests *Tool adjustable in 5° increments. Factory set at 70°* £310.00
- Footplate Selection** *Includes heel loops*
- Flip-up, Extruded Footplates, 7.25"W x 6"D, Pair Standard
- Angle Adjustable Footplates, 6"W x 8"D, Pair *Other sizes available* £115.00

*Please provide the seat pan to heel measurement required, minimum 11", maximum 19.5": \_\_\_\_\_*

- Heavy duty, drop in, swing-away legrests with angle adjustable footplates £340.00
- Legrest Angle** | **Footplate Selection** *Includes heel loops*
- 70°     80°    |     6"W x 8"D     8"W x 11"D *Other sizes available*

*Please provide the seat pan to heel measurement required, minimum 12", maximum 18": \_\_\_\_\_*

- 90° Paediatric Swing-Away Legrests *Seat Pan to Heel range of adjustment 7"-10"L. Includes 4" x 6"D angle adjustable footplates and heel loops* £310.00

- 70° Tapered Legrests *Not available with seat widths 17" or less* £310.00
- Footplate Selection** *Includes heel loops*
- Flip-up, Extruded Footplates, 7.25"W x 6"D, Pair Standard
- Angle Adjustable Footplates, 6"W x 8"D, Pair £115.00

*Please provide the seat pan to heel measurement required, minimum 11", maximum 19.5": \_\_\_\_\_*

## Elevating Legrests

*Choose instead of centre mount foot platform options*

- Manual Elevating Swing-Away Legrests *Not suitable for occupied transportation* £275.00
- Footplate Selection** *Includes heel loops*
- Flip-up, Extruded Footplates, 7.25" W x 6"D, Pair Standard
- Angle Adjustable Footplates, 6" W x 8"D, Includes Wheel Bumpers, Pair *Other sizes available* £115.00

*Please provide the seat pan to heel measurement required, minimum 11", maximum 18": \_\_\_\_\_*

- 70° Euro Power Elevating Swing-Away Legrests. *Includes calf pads* £720.00
- Footplate Selection** *Includes heel loops*
- Flip-up, Extruded Footplates, 7.25"W x 6"D, Pair Standard
- Angle Adjustable Footplates, 6"W x 8"D, Pair *Other sizes available* £115.00

*Please provide the seat pan to heel measurement required, minimum 11", maximum 18": \_\_\_\_\_*

- 70° Power Articulating Elevating Swing-Away Legrests *4" articulation range.* £1100.00
- Footplate Selection** *Includes heel loops*
- Angle Adjustable Footplates, 6"W x 8"D, Includes Wheel Bumpers, Pair *Other sizes available* Standard

*Please provide the seat pan to heel measurement required, minimum 11", maximum 18": \_\_\_\_\_*

**Accessories:**

- Small Calf Pads, Pair 5.35"W-6"H    or     Large Calf Pads, Pair 5.86"Wx8"H £88.00

- Gel Padded Adductor Buttons, Pair £30.00

- Operation Method:**     Independent     Combined

## Additional Legrest Options

- Stump Board support (each) *Includes a 60-90° Swing-Away Legrest hanger*     Left     Right £300.00
- Residual Limb support (each)     Left     Right £180.00

*If both a left and right support are required, please amend price accordingly*

## VR2 Non-Expandable Controls

- VR2 Joystick Standard
- Dual Control £380.00

## Joystick Handles

- |   |   |  |
|---|---|--|
| <input type="checkbox"/> Standard Carrot Handle |   | Standard   |
| <input type="checkbox"/> Mushroom Handle        | <input type="checkbox"/> Extended I-Handle  | £35.00 (each)  |
| <input type="checkbox"/> T-Bar                  | <input type="checkbox"/> Soft Ball Handle   | <input type="checkbox"/> Bodypoint 3 Inch Goal Post Handle |
| <input type="checkbox"/> Chin Cup               | <input type="checkbox"/> Medium Ball Handle | <input type="checkbox"/> Bodypoint 4 Inch Goal Post Handle |

## Joystick Mounting Brackets



- |  |          |
|--|----------|
| <input type="checkbox"/> Fixed, Inline                                 | Standard |
| <input type="checkbox"/> Swing-Away                                    | £75.00   |
| <input type="checkbox"/> Multi-Axis                                    | £125.00  |
| <input type="checkbox"/> Mount User Joystick as Attendant Control Only | £100.00  |
- Mounting Position**
- |                                 |    |  |
|---------------------------------|----|--|
| <input type="checkbox"/> Left   | or | <input type="checkbox"/> Right   |
| <input type="checkbox"/> Inline | or | <input type="checkbox"/> Offset <small>Not available with Fixed Joystick Bracket</small> |

## Speed Program and Lights Package

- |  |          |
|--|----------|
| <input type="checkbox"/> 4 Mph program                             | Standard |
| <input type="checkbox"/> 4 Mph program, with Lights and indicators | £400.00  |

## Quantum Accessories

*Some accessories will be shipped with the unit, not installed. Multiple accessories can be mounted along the various tracks, some interference may occur.*

- |                          |   |   |         |
|--------------------------|---|---|---------|
| <input type="checkbox"/> |    | Glove Box Supplied uninstalled  | £30.00  |
| <input type="checkbox"/> |   | Clothing Guard (pair) <small>Only available with Flip Up armrests</small> | £100.00 |
| <input type="checkbox"/> |  | Quantum Backpack  | £40.00  |

## Price

<b>Sub Total:</b>	£3,750.00
<b>Options:</b>	
<b>Total:</b>	

## Special Instructions

---



---



---



---



---

**For additional seating options such as thoracic supports and alternative drive controls please refer to secondary order forms, entitled 'Additional Seating Options' or 'Specialty Control Input Devices'.**

### Quantum Notes:

1. This product is suitable for occupied transportation in accordance with ISO 7176-19. We strongly recommend that all heavy accessories such as manual ELRs are removed and secured during occupied transportation. We also advise that the use of third party accessories including life Support Systems, Chin Controls and Trays be risk assessed prior to the wheelchair being transported. Full details of suitable restraints for this wheelchair can be obtained from Quantum Technical on 01869 324600 or Email us on: [technical@quantumrehab.co.uk](mailto:technical@quantumrehab.co.uk)
2. Due to manufacturing tolerances and continual product improvement, this specification can be subject to variance of + or - 3 %. Overall measurements will vary based on seating and accessory selections.